

Blueair Aware

User Manual



The intelligent, Wi-Fi enabled Blueair Aware™ uses high-tech sensors to measure indoor air pollution. Data is sent to your smartphone so you can monitor the air quality in your home from anywhere – and if needed take action to improve it.

Blueair Aware can also be set to automatically control a Blueair Sense+™ air purifier, giving you better air quality in the simplest possible way.

Before using Blueair Aware, please read this user manual carefully.

Content

General safety information	4
Start it	6
Place it	7
Set it	7
Read it	8
Care for it	9
Help and support	10
Warranty information	10
Technical specifications	11

Welcome to your new air monitor

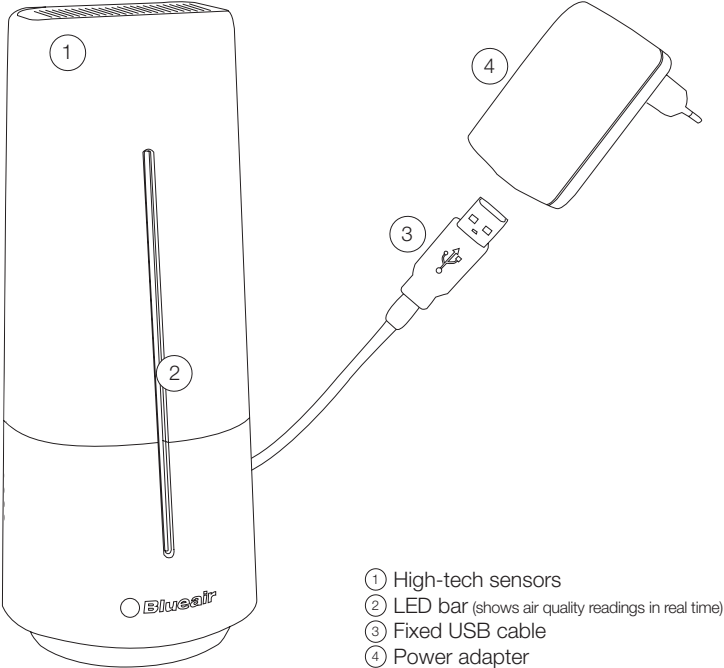

- ① High-tech sensors
- ② LED bar (shows air quality readings in real time)
- ③ Fixed USB cable
- ④ Power adapter

General safety information

Never inject gases or pollutants, or blow smoke or fumes directly toward the device. Exposure to an excess of pollutants may permanently damage sensing capacity.

- ⊘ Never use Blueair Aware:
 - Under conditions of extreme temperature or humidity
 - Outdoors
 - Near potted plants
 - In a dusty environment, such as a building with ongoing renovation
 - Close to silicone-based glue or any product releasing silicone fumes

- ⊘ Never place Blueair Aware:
 - In the sun
 - Near heat or flames
 - In/under/next to liquids
 - With anything on top of it or covering it
 - In a closet or drawer

Misuse can cause burns, fire, electrocution, and other hazards.

- ⊘ Never clean Blueair Aware with:
 - Water or spray
 - A feather duster
 - A vacuum cleaner

- ⊘ Please do not:
 - Try to open the device or make modifications to it
 - Use the device if it has any damage or isn't working properly
 - Plug/unplug the device frequently
 - Let children under 8 years use the device
 - Please do not use the device with any non-Blueair accessories.

IMPORTANT INFORMATION REQUIRED BY THE FCC

The user manual or instruction manual for an intentional or unintentional radiator shall caution the user that changes or modifications not expressly approved by the party responsible for compliance could void the user's authority to operate the equipment.

This device complies with part 15 of the FCC Rules. Operation is subject to the following two conditions: (1) This device may not cause harmful interference, and (2) this device must accept any interference received, including interference that may cause undesired operation.

FCC Radiation Exposure Statement:

This equipment complies with FCC radiation exposure limits set forth for an uncontrolled environment. In order to avoid the possibility of exceeding the FCC radio frequency exposure limits, Human proximity to the antenna shall not be less than 20 cm (8 inches) during normal operation.



FCC ID: 2AEX3-AAWARE
IC NO: 20267-AAWARE

Start it

1. Plug Blueair Aware into an electrical outlet with the supplied power adapter.

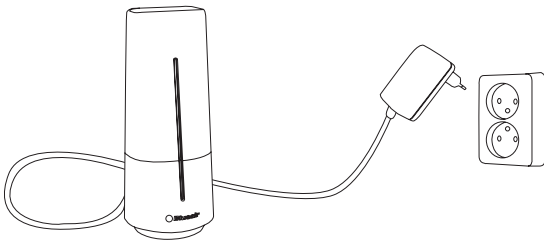

2. Download the Blueair Friend™ app to your smartphone (available for iPhone and Android).

3. Make sure your smartphone is connected to the Wi-Fi network you want Blueair Aware to be connected to. Start the app and follow setup instructions. For more information, tap on ⓘ (Support) ► "FAQ" or "Troubleshooting".

4. Now Blueair Aware is connected with your smartphone and ready to guide you.
-

Place it

Blueair Aware should be placed in the room you want to monitor on a flat, stable surface with open air around it – preferably at the normal height level of your nose. For example, on a bookshelf or a side table in the living room or a nightstand in a bedroom. The more open the placement, the better the air reading and Wi-Fi connection.

Set it

In the Blueair app, tap on 🏠 (Indoor Air) ► choose the Blueair Aware you want to set by swiping left or right ► tap on cog ⚙️ (settings). Here you can change:

LED intensity

- ☀️ Tap in circle to change intensity. Off = all bars are grey.
- 🌙 Tap in circle to switch LED on/off. This setting will only apply during the times that Night mode is set for.
 - ⌚ Tap in circle to set start and end time.

If you have both a Blueair Aware and a Blueair Sense+ air purifier, you can set the monitor to automatically control the Sense+. Please read the Sense+ user manual about how to switch on Auto mode.

Read it

You can view how clean your indoor air is both on the Blueair Aware device itself and in the Blueair app.

On the device the air readings are visualized in real time on an LED bar:

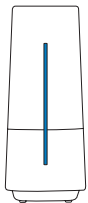

Excellent air quality

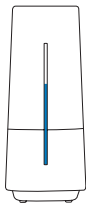

Good air quality

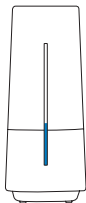

Moderate air quality



Slightly polluted air

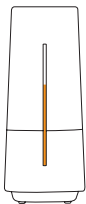

Polluted air
Actions recommended

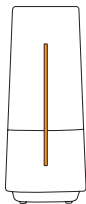

Highly polluted air
Actions vital

In the app the air quality readings are presented as values of:

- PM2.5 – Particulate matter (e.g. outdoor pollution and smoke)
- VOC – Volatile organic compounds (e.g. detergent and color)
- CO₂ – This is a CO₂e reading* (Carbon dioxide equivalent)
- Temperature (°F/°C)
- Humidity (%)

** Our CO₂ equivalent reading is based on VOC gases measured by our sensor. The reading is a good indicator of CO₂ in indoor environments.*

In the app, tap on the value in the big circle to get more information and recommendations. For detailed information about threshold levels, tap on ⓘ (Support) ► “FAQ” ► “Measuring air quality”.

Note: Blueair Aware is designed for continuous monitoring, which means the readings will become more stable over time and optimal after about a week. Usage conditions can influence the accuracy.

Care for it

- Clean the casing only with an anti-static cloth.
 - If your air quality levels seem abnormal, start the app and tap on ⓘ (Support) ► “Troubleshooting”.
-

Help and support

For more information, start the Blueair app and tap on ⓘ (Support) ► “Troubleshooting”. If you can’t solve the issues, please visit www.blueair.com or contact your local Blueair retailer.

Warranty information

Blueair warrants the included hardware product and accessories against defects in materials and workmanship. Warranty benefits may vary locally. Full terms and detailed information about what applies in your country is available at www.blueair.com. To extend your limited warranty, register in the Blueair app (tap on “Profile”) or on our website.

Technical specifications

Air Quality Sensing:	Particulate matter
	Total VOC
	Carbon Dioxide
	Temperature
	Humidity
Size Product (HxWxD):	194x80x80 mm (7.6x3x3 in)
Weight Product (incl. adapter):	410 g
Power:	Non detachable USB cable, 1,7 m
Connectivity:	Wi-Fi: 802.11B/G/N
	Wi-Fi GHz: 2.4
	Security: Open/WEP/WPA/WPA2 Personal
	Sends and stores data every 5 minutes
	On demand instant measurements
	iPhones with iOS 8 and upwards
	Android 4.1 and upwards
	The entire unit can be recycled

External network issues affecting the product performance are beyond the control of Blueair. Please contact your Internet service provider for assistance.



KLIMASKLEP, ul. Orzechowa 3, 72-010 Przęsocin (koło Szczecina)
tel.: (91) 432-43-42, tel.: (91) 432-43-49
e-mail: sklep@klimasklep.pl, www: www.KlimaSklep.pl

Blueair AB

Danderydsgatan 11
SE-114 26 Stockholm
Sweden
Tel: +46 8 679 45 00
Fax: +46 8 679 45 45
info@blueair.se

Blueair Inc.

Suite 1900,
100 N LaSalle Street
Chicago, IL 60602
Tel: +1 888 258 3247
Fax: +1 312 727 1153
info@blueair.com

Blueair (Shanghai) Trading Co. Ltd.

Rm 1005 City Gateway
No. 398 North Caoxi Road
Xuhui Distr, Shanghai
Tel: +86 21 6091 0981
Fax: +86 21 6091 0989
info@blueair.cn

Blueair India

Embassy of Sweden
Nyaya Marg, Chanakyapuri
New Dehli – 110021
Tel: +91 11 4606 7121
Fax: +91 11 4606 7120
india@blueair.se